



4045/4046 Series

Phenolic and Glass Meters



4-1/2"
 4045 ■ D.C. Moving Coil
 4046 ■ A.C. Repulsion

FEATURES

- Handsomely styled to meet the most demanding appearance requirements.
- This series conforms to the standards for 2-1/2", 3-1/2", 4-1/2" 4 hole mounting to provide for interchanging with other similar size meters.
- These are high quality instruments, available in AC and DC models including D'Arsonval 2% accuracy DC, AC repulsion and rectifier type movements.

NOTE:
 UL recognized version available.
 To order add - UL to model.

DIMENSIONS

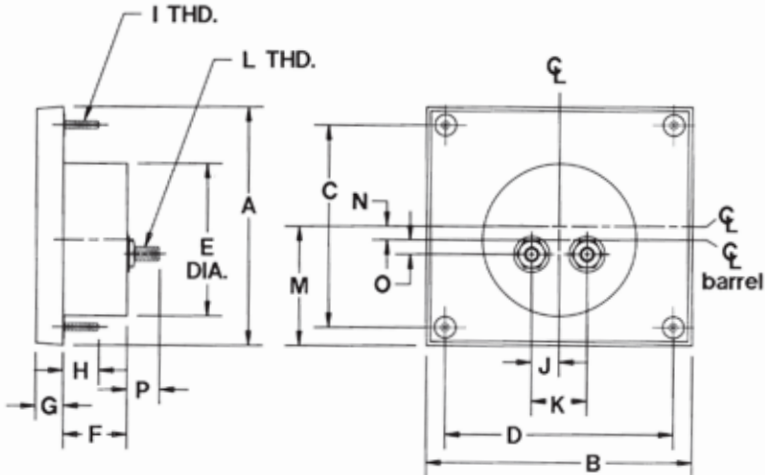

| MODELS | A | B | C | D | E | F | G | H | I | J | K | L | M | N | O | P |
|---------|------|------|------|------|------|------|------|------|------|------|------|-------|------|------|------|------|
| 4045/46 | 4.20 | 4.66 | 3.56 | 4.00 | 2.69 | 1.12 | 0.47 | 0.62 | 6-32 | 0.48 | 0.97 | 10-32 | 2.10 | 0.24 | 0.25 | 0.50 |