



# 2018 Series

## Panel Mount Meters



1-1/2"  
2018/22 ■ D.C. Moving Coil  
2018R ■ A.C. Rectifier

### FEATURES

- These attractively styled meters are produced in five sizes from 1-1/2" to 6".
- All models have long, flat arc scales and knife edge pointers for excellent readability.
- Most 1-1/2" to 6" meters are supplied with the self shielded Accuring movements.
- Features for the 2000 series include matching AC and DC models, bezel or surface mounting, and choice of standard colors on the lower front cover at additional cost.
- Standard ranges for this series of meters, both AC and DC, are listed on the Hoyt price sheet and include DC Microamps, Milliamps, Millivolts, Volts, and Amps; AC Milliamps, Amps and Volts.
- Special dials are available

### SPECIFICATIONS

- Accuracy:  $\pm 2\%$  full scale value.
- Resistance:  $\pm 15\%$
- Dials: 100 or 90 degree arc, black lettering on white background. Special dial colors and artwork are available as an option.
- Movement: Spring loaded pivot and jewel movement that assures maximum torque and readability.
- D.C. Ranges: Microammeters, Milliammeters, Ammeters, Millivoltmeters and Voltmeters.
- A.C. Ranges: Milliammeters, Ammeters, and Voltmeters.
- Mounting: Specify (HS) Surface mount, (HB) Bezel mount.
- Standard Options: Optional colors available on lower front cover, mirror dials, acrylic.
- Case Construction: This series has clear polystyrene cases standard, but acrylic or high impact polycarbonate case are available in some models.

### 2000 SERIES BEZELS



#### Bezel Mount Meters

Bezels for mounting rectangular custom series models 2018, 2025/26, 2035/36, and 2045/46\* behind the panel are sturdy, die cast black metal. Bezel mount meters may be ordered with optional quick mount positive locking tabs.

#### Bezel Part Numbers

C-7052 (overall size 2" x 1-3/16") for 2018

C-7036 (overall size 3-1/8" x 1-23/32") for 2025/26

C-7048 (overall size 3-7/8" x 2-9/32") for 2035/36

C-7030 (overall size 4-31/32" x 2-29/32") for 2045/46\*

\*Polycarbonate



# 2018 Series

## Panel Mount Meters

### DIMENSIONS

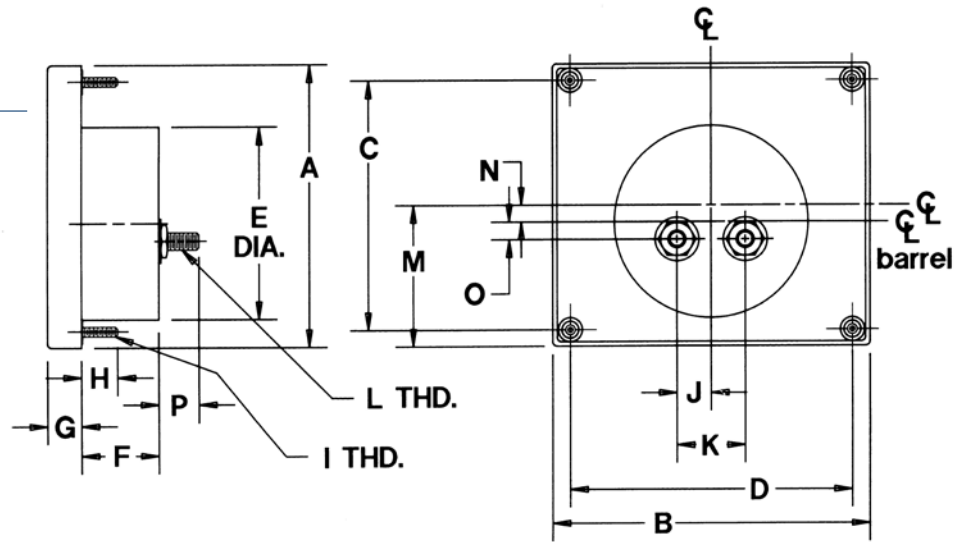

MODELS	A	B	C	D	E	F	G	H	I	J	K	L	M	N	O	P
2018-22/18R	1.74	1.74	1.31	1.31	1.50	1.22	0.33	0.50	4-48	0.48	0.97	10-32	0.87	0.00	-.22	0.50

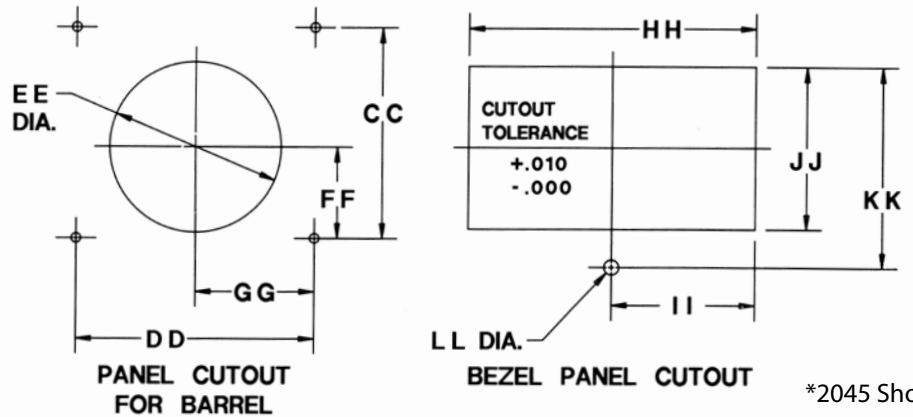

\*2045 Shown

MODELS	CC	DD	EE	FF	GG	HH	II	JJ	KK	LL
2018-22/18R	1.31	1.31	1.60	0.66	0.66	1.91	0.95	1.12	1.48	0.20